

Bang & Olufsen

BEOGRAM 5000, type 580x

BEOGRAM 2000, type 582x

CAVALLERS CORTSAVI, le Labo Audio du Vallespir
 Maintenance Electronique Audio Hifi Musique Radio Sono
 66150 CORSAVY - France
 04 68 37 07 19 - 06 50 91 17 21
<http://audio-labo-vallespir.com/>

Types 5804-5823 PCB 1 = 8005102

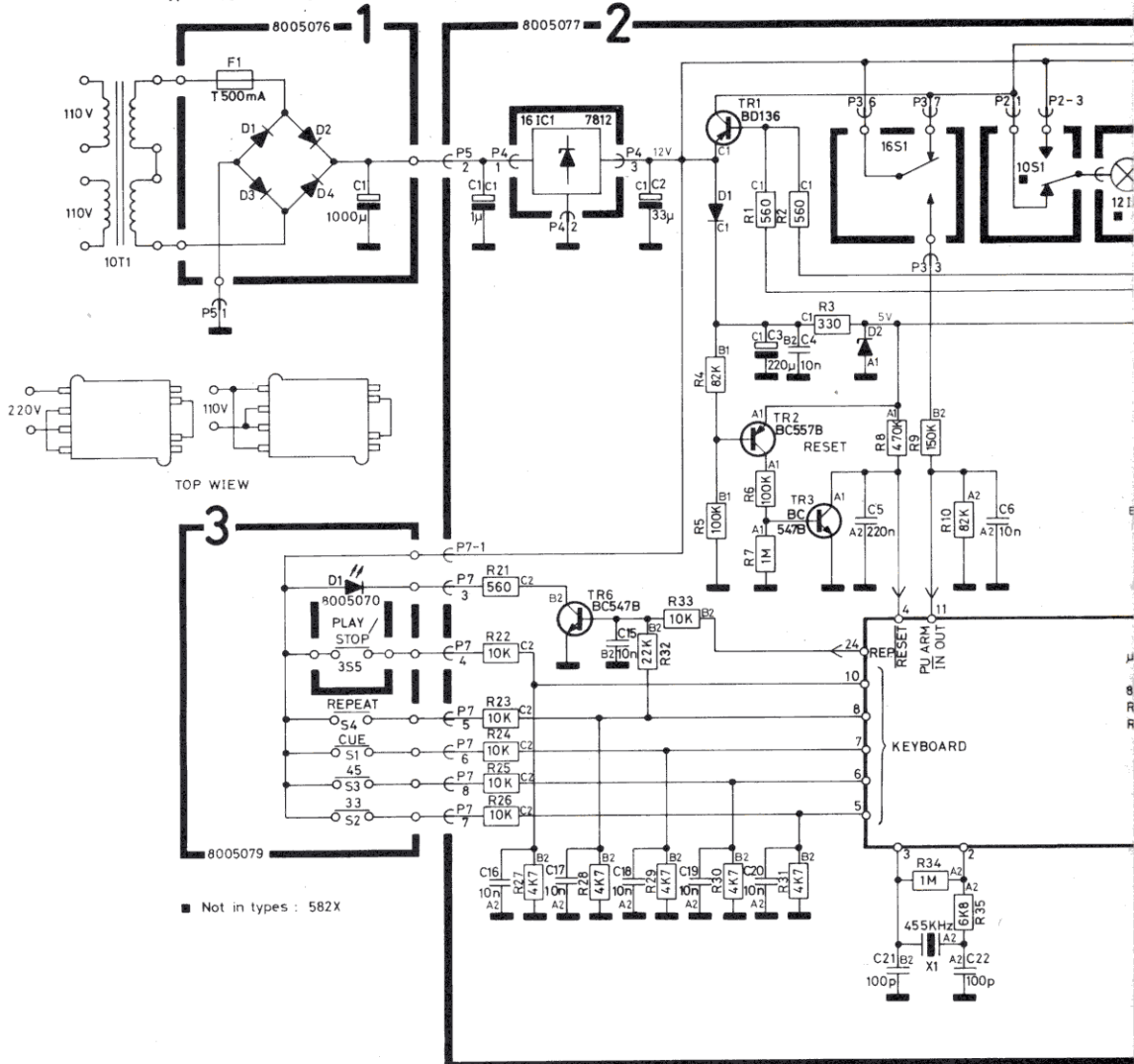

PASTE INTO SERVICE MANUAL BEOGRAM 1800

■ Not in types : 582X

| | ACTIVATE | PLAY-STOP | | | CUE | | PLAY-STOP | | | CUE | | | RUN OFF STOP | | | | | | |
|----------------------|----------------|--|---------------|---------------|---------|-------------|-----------|---------------|---------|-------------|---------------|------|----------------|----------------|---------|--------------|---------------|------|--|
| | | 17 cm record on turntable | PU in 27-3sec | PU down 18sec | Playing | PU up 18sec | Pause | PU down 18sec | Playing | PU up 18sec | PU out 2.7sec | Stop | PU in 2.7-3sec | PU down 1.8sec | Playing | PU up 1.8sec | PU out 2.7sec | Stop | |
| PU arm in/out output | PIN 23 (16RL1) | [Timing diagram showing pulses for activate, play-stop, cue, and run off stop] | | | | | | | | | | | | | | | | | |
| 30/17 cm. input | *PIN 13 (16S2) | [Timing diagram showing constant low signal] | | | | | | | | | | | | | | | | | |
| PU arm in/out input | PIN 11 (16S1) | [Timing diagram showing pulses] | | | | | | | | | | | | | | | | | |
| Lift/lower output | PIN 22 (16RL2) | [Timing diagram showing pulses] | | | | | | | | | | | | | | | | | |
| Lift/lower input | PIN 12 (16S3) | [Timing diagram showing pulses] | | | | | | | | | | | | | | | | | |

* PIN 13 is constant low with 30 cm. record

| | | | |
|-------|----|---------|----|
| GND | 1 | 24 | D0 |
| CK0 | 2 | 23 | D1 |
| CK1 | 3 | 22 | D2 |
| RESET | 4 | 21 | D3 |
| L7 | 5 | COP 410 | 20 |
| L6 | 6 | 19 | G2 |
| L5 | 7 | 18 | G1 |
| L4 | 8 | 17 | G0 |
| Vcc | 9 | 16 | SK |
| L3 | 10 | 15 | S0 |
| L2 | 11 | 14 | S1 |
| L1 | 12 | 13 | L0 |

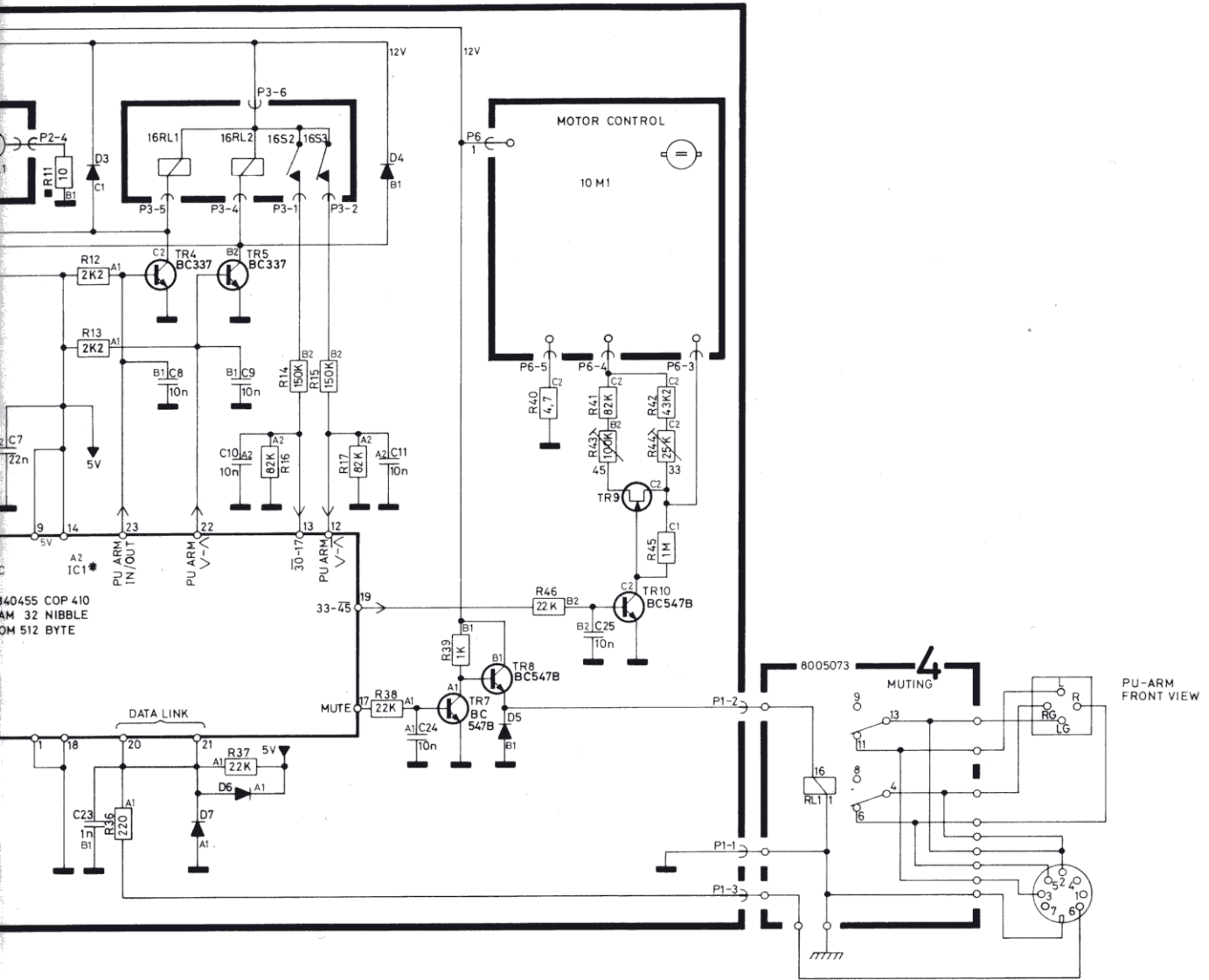

Explanation of the fuse symbols used in the set:

Explication des symboles du fusible utilisés dans l'appareil:

Replace with same type 500 mA-250 V slow acting fuse.

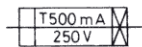

Remplacer par un fusible de meme type retarde et de 500 mA-250 V.